



HILLINGDON
LONDON



NOTICE OF HEARING

Licensing Sub-Committee

Date: TUESDAY, 30 JULY 2019

Time: 10.00 AM

Venue: COMMITTEE ROOM 5 -
CIVIC CENTRE, HIGH
STREET, UXBRIDGE

Meeting Details: Members of the Public and Media are welcome to attend. This meeting may also be broadcast live.

If this is a public hearing, the agenda is available online at www.hillingdon.gov.uk or you can use a smart phone camera and scan the code below:



Councillors on the Sub-Committee:

Roy Chamdal (Chairman)

Simon Arnold

John Oswell

IMPORTANT INFORMATION

On receipt of this notice, you **MUST** notify the Committee Clerk (contact details below) by the following date:

Thursday 25 July 2019

If you don't notify you may lose your right to speak at the hearing. When notifying you must confirm:

- 1) Whether you intend to attend or to be represented by someone at the hearing;
- 2) If you consider a hearing to be unnecessary and;
- 3) Whether to request that another person attends (other than your representative) as a witness

Published: Monday, 15 July 2019

Contact: Luke Taylor

Tel: 01895 250 693

Email: ltaylor3@hillington.gov.uk

Putting our residents first

Lloyd White
Head of Democratic Services
London Borough of Hillingdon,
Phase II, Civic Centre, High Street, Uxbridge, UB8 1UW

Useful information for residents and visitors

Watching & recording this meeting (if a public meeting only)

If this meeting is to be held in Public (Part 1) you can watch it on the Council's YouTube channel, live or archived after the meeting. Residents and the media are also welcome to attend in person, and if they wish, report on the public part of the meeting. Any individual or organisation may record or film proceedings as long as it does not disrupt proceedings.

Watch a **LIVE** broadcast of this meeting on the Council's YouTube Channel: *Hillingdon London*

Those attending should be aware that the Council will film and record proceedings for both official record and resident digital engagement in democracy.



It is recommended to give advance notice of filming to ensure any particular requirements can be met. The Council will provide seating areas for residents/public, high speed WiFi access to all attending and an area for the media to report. The officer shown on the front of this agenda should be contacted for further information and will be available to assist.

When present in the room, silent mode should be enabled for all mobile devices.

Travel and parking

Bus routes 427, U1, U3, U4 and U7 all stop at the Civic Centre. Uxbridge underground station, with the Piccadilly and Metropolitan lines, is a short walk away. Limited parking is available at the Civic Centre. For details on availability and how to book a parking space, please contact Democratic Services. Please enter from the Council's main reception where you will be directed to the Committee Room.



Accessibility

For accessibility options regarding this agenda please contact Democratic Services. For those hard of hearing an Induction Loop System is available for use.

Emergency procedures

If there is a FIRE, you will hear a continuous alarm. Please follow the signs to the nearest FIRE EXIT and assemble on the Civic Centre forecourt. Lifts must not be used unless instructed by a Fire Marshal or Security Officer. In the event of a SECURITY INCIDENT, follow instructions issued via the tannoy, a Fire Marshal or a Security Officer. Those unable to evacuate using the stairs, should make their way to the signed refuge locations.

Agenda

CHAIRMAN'S ANNOUNCEMENTS

Hearing Protocol

- 1 Apologies for Absence
- 2 Declarations of interest in matters coming before this meeting
- 3 To confirm that the items of business marked Part I will be considered in Public and items marked Part II will be considered in Private
- 4 Matters that have been notified in advance or urgent

Part I - Members, Public and Press

	Title of Report / Address of application	Ward	Time	Page
5	Application for the grant of a Premises Licence: Eastcote Karahi, 105 Field End Road, Eastcote, HA5 1QG	Eastcote & East Ruislip	10:00am	3 - 56

This page is intentionally left blank

Order of proceedings – application under the Licensing Act 2003

The Chairman of the Sub-Committee will open the hearing by introducing the Councillors, explaining the purpose of the proceedings and the general procedure. The Chairman will then check that there are no additions or alterations to the list of those appearing at the hearing.

Introduction by the Regulatory Services/Licensing Officer



The Applicant / Licence Holder



Responsible Authorities (if present)



Other Parties (residents etc...)



DISCUSSION LED BY THE SUB-COMMITTEE

The Chairman will lead the discussion. This will be a chance for all parties to provide comments on any submissions that have been made to the Sub-Committee.



Closing remarks from each party



Sub-Committee deliberates



Chairman announces the decision

The Council's Regulatory Services/Licensing Officer will introduce the report and will outline the matter before the Sub-Committee, giving any relevant background information. The Sub-Committee may ask questions of the officer.

The Applicant, licence holder or the person representing him/her will be invited to address the Sub-Committee. They will be allowed sufficient time to present his/her case. The Sub-Committee may ask questions.

Responsible Authorities will be invited to address the Sub-Committee and will be allowed sufficient time. The Sub-Committee may ask questions of the Responsible Authorities.

Other parties will be invited to address the Sub-Committee. Where there are a number of parties making similar representations the Chairman will expect the parties to nominate a spokesperson to make the representations and all will be allowed sufficient time. The Sub-Committee may ask questions of the Other Parties.

The Chairman will invite the Responsible Authorities and Other Parties to make brief closing remarks on the application. The Applicant / licence holder makes the final closing remarks.

The Sub-Committee will remain in the room to deliberate and make their decision, with only the Legal Advisor and the Clerk to the Sub-Committee remaining. All others present will be asked to leave the room. If the meeting is being broadcast, any filming will be stopped for this part.

Parties may return to the room when invited to do so and the Chairman will announce the decision. The Chairman will remind the Applicant / licence holder that the decision will be sent to them in writing. There can be no further questions or statements.

This page is intentionally left blank

APPLICATION FOR THE GRANT OF A PREMISES LICENCE: EASTCOTE KARAHİ

Committee	Licensing Sub-Committee
Officer Contact	Mark McDermott, Licensing Officer
Papers with report	Appendix 1 - Application for the grant of a new premises licence Appendix 2 - Summary of amendments to application Appendix 3 - Representation from local resident, Paul Faith Appendix 4 - Representation from local resident, Caren Westhead Appendix 5 - Representation from local resident, Matthew Westhead Appendix 6 - Map of the area Appendix 7 - Photo of the premises Appendix 8 - Lapsed Licence
Ward name	Eastcote and East Ruislip

1.0 SUMMARY

To consider an application for a premises licence, as seen in **Appendix 1**, in respect of Eastcote Karahi, 105 Field End Road, Eastcote, HA5 1QG. This has attracted representations from three interested parties.

2.0 RECOMMENDATION

To grant the licence, consistent with the operating schedule conditions and amendments/additions as sought, but to reduce the terminal hour for late night refreshment, sale of alcohol and opening hours to midnight on Friday and Saturday, due to the close proximity of residential properties above the premises.

3.0 APPLICATION

3.1 Licensable Activities

<u>Activity</u>		<u>Proposed for new premises licence</u>
Recorded Music	Indoors	x
Late Night Refreshment	Indoors	x
Sale of alcohol	Consumption on the premises	x

3.2 Opening Hours and proposed hours for licensable activity

	Recorded Music	Proposed hours for sale by retail of alcohol
Monday	18:00 - 01:00	12:00 - 01:00
Tuesday	18:00 - 01:00	12:00 - 01:00
Wednesday	18:00 - 01:00	12:00 - 01:00
Thursday	18:00 - 01:00	12:00 - 01:00
Friday	18:00 - 01:30	12:00 - 01:00
Saturday	18:00 - 01:30	12:00 - 01:00
Sunday	18:00 - 00:00	12:00 - 00:00

	Proposed Late Night Refreshment Hours	Opening hours of the premises
Monday	23:00 - 01:00	12:00 - 01:00
Tuesday	23:00 - 01:00	12:00 - 01:00
Wednesday	23:00 - 01:00	12:00 - 01:00
Thursday	23:00 - 01:00	12:00 - 01:00
Friday	23:00 - 01:30	12:00 - 01:30
Saturday	23:00 - 01:30	12:00 - 01:30
Sunday	23:00 - 00:00	12:00 - 00:00

The new premises licence application has been made by **Eastcote Karahi Limited** for a restaurant situated at 105 Field End Road, Eastcote, HA5 1QG.

On receipt of representations, officers entered into mediation between the applicant and the objectors to see if concerns raised could be resolved by way of amendments to the operating schedule. This led to the applicant amending the application, as shown at **Annex 2** and detailed below (3.3 to 3.8).

3.3 Type of application applied for

New Premises Licence application under Licensing Act, 2003.

3.4 Description of the premises

The premise is a single unit restaurant on the ground floor with residential flats above situated on a parade of shops on a busy high street.

3.5 Revised Licensable Activities following mediation

<u>Activity</u>		<u>Proposed for new premises licence</u>
Late Night Refreshment	Indoors	x
Sale of alcohol	Consumption on the premises	x

3.6 Revised opening Hours and proposed hours for licensable activity following mediation

	Opening hours of the premises	Proposed hours for sale by retail of alcohol
Monday	12:00 - 00:00	12:00 - 00:00
Tuesday	12:00 - 00:00	12:00 - 00:00
Wednesday	12:00 - 00:00	12:00 - 00:00
Thursday	12:00 - 00:00	12:00 - 00:00
Friday	12:00 - 01:00	12:00 - 01:00
Saturday	12:00 - 01:00	12:00 - 01:00
Sunday	12:00 - 00:00	12:00 - 00:00

	Proposed hours Late Night Refreshment
Monday	23:00 - 00:00
Tuesday	23:00 - 00:00
Wednesday	23:00 - 00:00

Thursday	23:00 - 00:00
Friday	23:00 - 01:00
Saturday	23:00 - 01:00
Sunday	23:00 - 00:00

3.7 Other licensed premises nearby

Premises	Activities Authorised	Times Authorised
Thai Lemon 91 Field End Road	Sale by Retail Of Alcohol Provision of regulated entertainment	<u>Sale of alcohol</u> From 11.00 hours to 23.00 hours every day <u>Regulated Entertainment</u> From 11.00 hours to 23.00 hours every day
Yi Ban 98 Field End Road	The sale by retail of alcohol Provision of regulated entertainment	<u>Sale of alcohol</u> From 12.00 hours until 23.00 hours, Monday to Saturday From 12.00 hours until 22.30 hours on Sunday <u>Regulated Entertainment</u> From 12.00 hours until 23.00 hours, Monday to Saturday From 12.00 hours until 22.30 hours on Sunday
Virundhu Restaurant 113 Field End Road	The sale by retail of alcohol The provision of regulated entertainment The provision of late night refreshment	<u>Sale of alcohol</u> On weekdays, between 10.00 and 24.00 hours. On Sundays between 12.00 and 23.30 hours. <u>Regulated Entertainment</u> The provision of recorded music is not time restricted <u>LNR</u> From 23.00 until 30 minutes after the terminal time for the sale of alcohol
Aroma Lounge 134 Field End Road	The sale by retail of alcohol The provision of regulated entertainment The provision of late night refreshment	<u>Sale of alcohol</u> On weekdays between 10.00 and 24.00 hours <u>Regulated Entertainment</u> On weekdays between 10.00 and 24.00 hours <u>LNR</u> From 23.00 until 30 minutes after the terminal time for the sale of alcohol
Ascott 144 Field End Road	The sale by retail of alcohol The provision of regulated entertainment The provision of late night	<u>Sale of alcohol</u> Monday and Tuesday between 11.00 and 23.00 hours Wednesday between 11.00 and 00.00

	refreshment	<p>hours Thursday, Friday and Saturday between 11.00 and 01.00 hours Sunday between 11.00 hours and 00.00 hours</p> <p><u>Regulated Entertainment</u> Monday and Tuesday between 11.00 and 23.00 hours Wednesday between 11.00 and 00.00 hours Thursday, Friday and Saturday between 11.00 and 01.00 hours Sunday between 11.00 hours and 00.00 hours</p> <p><u>LNR</u> Wednesday between 23.00 hours and 00.00 hours Thursday, Friday and Saturday between 23.00 hours and 01.00 hours the following day Sunday between 23.00 hours and 00.00 hours</p>
--	-------------	--

3.8 Operating Schedule and Conditions

Section 18 of the operating schedule of the Application demonstrates the steps the applicant proposes to take in order to promote the licensing objectives.

General

1. Alcohol only can be sold with table meals.

The Prevention of crime and disorder

2. The installed CCTV system shall be maintained in effective working order at all times. The CCTV system shall retain all recordings for a minimum of 31 days and shall contain the correct date and time of the image capture. Recordings shall be made available immediately upon request to the Police and/or authorised officers of the London Borough of Hillingdon.
3. Alcohol will not be accessible to members of the public.

Public Safety

4. A Fire alarm system shall be installed.
5. Staff shall be trained in respect of evacuation procedure

The prevention of public nuisance

6. All refuse shall be kept in waste containers.
7. No noise shall emanate from the premises nor vibration be transmitted through the structure of the premises that gives rise to a nuisance.

8. The external back door shall be kept closed between 19.00 hours and [closing] hours, except for the immediate access and egress of persons.
9. Notices shall be prominently displayed near the entrance and exit doors requesting patrons to respect the needs of local residents and leave the area quietly.
10. Staff shall monitor customers smoking outside the premises on a regular basis to ensure patrons do not cause a public nuisance.

The protection of children from harm

11. A Challenge 25 scheme shall be operated at the premises. Only photographic ID shall be acceptable as proof of age (passport, photo driving licence, or PASS card).
12. Staff shall be trained in responsible alcohol retailing. Staff training records shall be made available for inspection upon request by officers of a Responsible Authority.

4.0 CONSULTATION

4.1 Closing date for representations

2 July 2019

4.2 Public Notice published in local newspaper

12 June 2019 - Uxbridge Gazette

5.0 REPRESENTATIONS

5.1 We have received three representations from residents'.

Interested Parties	Ground for Representation	Appendix
Mr Paul Faith	Prevention of Public Nuisance. Protection of Children From Harm	Appendix 3
Ms Caren Westhead	Prevention of Crime and Disorder, Prevention of Public Nuisance	Appendix 4
Mr Matthew Westhead	Prevention of Public Nuisance, Protection of Children From Harm	Appendix 5

6.0 BACKGROUND INFORMATION

6.1 Designated Premises Supervisor

The applicant has not included a DPS on the application form and has stated that alcohol will not be sold until a Designated Premises Supervisor has been added to the Licence if granted. The absence of a DPS on the application does not prevent the application from being granted.

6.2 Map of the area and photos of the premises and the surrounding area are attached as **Appendices 6 and 7.**

6.3 There have been no recorded Members' Enquires for this premises.

7.0 OFFICER'S OBSERVATIONS

- 7.1 This is an application for a premises licence for a restaurant. This premises previously benefitted for a premises licence for a restaurant known as Ortenzi, that was surrendered on 19 November 2018 attached as **Appendix 8**.
- 7.2 The representations received mainly raise the following issues:
- a) **The prevention of crime and disorder** - Two of the representations received from interested parties refer to the crime and disorder objective but they are based on general problems in the area that cannot be attributed to the premises as they have not started trading.
 - b) **The prevention of public nuisance** - All three of the representations received from interested parties refer to the public nuisance objective. The main concerns raised were directly connected to the proposed hours of sale of alcohol. The view taken is that the hours of operation were excessive and would cause noise disturbance for residents in the residential premises above the premises, along with litter and a nuisance being caused by additional traffic outside the premises. In accordance with the Council's Licensing Policy, arbitrary restrictions that would undermine the principle of flexibility are best avoided and each case is judged on its individual merits. As Hillingdon does not have a Cumulative Impact Policy there is no fixed restriction on terminal hours for any particular areas of the borough. The applicant has reduced the hours applied for, withdrawn recorded music and offered additional conditions following concerns raised by the objectors to demonstrate the promotion of this licensing objective.
 - c) **The protection of children from harm** - One representation refers to the protection of children from harm objective regarding disturbance that may be caused to children who live in the residential premises above the restaurant. It should be noted that the premises does not have shared access with the residential properties.

8.0 Relevant sections of S.182 Guidance

Determining actions that are appropriate for the promotion of the licensing objectives

At paragraph 9.42 it states that "Licensing authorities are best placed to determine what actions are appropriate for the promotion of the licensing objectives in their areas. All licensing determinations should be considered on a case-by-case basis. They should take into account any representations or objections that have been received from responsible authorities or other persons, and representations made by the applicant or premises user as the case may be".

At paragraph 9.43 it states that "The authority's determination should be evidence-based, justified as being appropriate for the promotion of the licensing objectives and proportionate to what it is intended to achieve".

At paragraph 9.44 it states that "Determination of whether an action or step is appropriate for the promotion of the licensing objectives requires an assessment of what action or step would be suitable to achieve that end. While this does not therefore require a licensing authority to decide that no lesser step will achieve the aim, the authority should aim to consider the potential burden that the condition would impose on the premises licence holder (such as the financial burden due to restrictions on licensable activities) as well as the potential benefit in terms of the promotion of the licensing objectives. However, it is 76 Revised Guidance issued under section 182 of the Licensing Act 2003 imperative that the authority ensures that the factors which form the basis of its determination are limited to consideration of the promotion of the objectives and nothing outside those parameters. As with the consideration of licence variations, the licensing authority should consider wider issues such as other conditions already in place to mitigate potential negative impact on the promotion of the licensing objectives and the track record of the business. Further advice on determining what is

appropriate when imposing conditions on a licence or certificate is provided in Chapter 10. The licensing authority is expected to come to its determination based on an assessment of the evidence on both the risks and benefits either for or against making the determination".

Proportionality

At paragraph 10.10 it states that "The 2003 Act requires that licensing conditions should be tailored to the size, type, location and characteristics and activities taking place at the premises concerned. Conditions should be determined on a case-by-case basis and standardised conditions which ignore these individual aspects should be avoided. For example, conditions should not be used to implement a general policy in a given area such as the use of CCTV, polycarbonate drinking vessels or identity scanners where they would not be appropriate to the specific premises. Conditions that are considered appropriate for the prevention of illegal working in premises licensed to sell alcohol or late night refreshment might include requiring a premises licence holder to undertake right to work checks on all staff employed at the licensed premises or requiring that a copy of any document checked as part of a right to work check is retained at the licensed premises. Licensing authorities and other responsible authorities should be alive to the indirect costs that can arise because of conditions. These could be a deterrent to holding events that are valuable to the community or for the funding of good and important causes. Licensing authorities should therefore ensure that any conditions they impose are only those which are appropriate for the promotion of the licensing objectives".

Hours of trading

At paragraph 10.13 it states "The Government acknowledges that different licensing strategies may be appropriate for the promotion of the licensing objectives in different areas. The 2003 Act gives the licensing authority power to make decisions about the hours during which premises can conduct licensable activities as part of the implementation of its licensing policy statement. Licensing authorities are best placed to make decisions about appropriate opening hours in their areas based on their local knowledge and in consultation with responsible authorities. However, licensing authorities must always consider each application and must not impose predetermined licensed opening hours, without giving individual consideration to the merits of each application"

At paragraph 10.15 it states "Shops, stores and supermarkets should normally be free to provide sales of alcohol for consumption off the premises at any times when the retail outlet is open for shopping unless there are good reasons, based on the licensing objectives, for restricting those hours".

Licensing hours

At paragraph 14.51 it states "With regard to licensing hours, the Government acknowledges that different licensing approaches may be appropriate for the promotion of the licensing objectives in different areas. The 2003 Act gives the licensing authority power to make decisions regarding licensed opening hours as part of the implementation of its licensing policy statement and licensing authorities are best placed to make such decisions based on their local knowledge and in consultation with other responsible authorities. However, licensing authorities must always consider each application and must not impose predetermined licensed opening hours, without giving individual consideration to the merits of each application".

At paragraph 14.52 it states "Statements of licensing policy should set out the licensing authority's approach regarding licensed opening hours and the strategy it considers appropriate for the promotion of the licensing objectives in its area. The statement of licensing policy should emphasise the consideration which will be given to the individual merits of an application. The Government recognises that licensed premises make an important contribution to our local communities, and has given councils a range of tools to effectively manage the different pressures that licensed premises can bring. In determining appropriate strategies around licensed opening hours, licensing authorities

cannot seek to restrict the activities of licensed premises where it is not appropriate for the promotion of the licensing objectives to do so".

The need for licensed premises

At paragraph 14.19 it states "There can be confusion about the difference between the "need" for premises and the "cumulative impact" of premises on the licensing objectives, for example, on crime and disorder. "Need" concerns the commercial demand for another pub or restaurant or hotel and is a matter for the planning authority and for the market. This is not a matter for a licensing authority in discharging its licensing functions or for its statement of Revised Guidance issued under section 182 of the Licensing Act 2003 I 109 licensing policy".

9.0 Relevant sections of the Licensing Policy

Licensing Hours

At Paragraph 21.1 it states that "Prior to the introduction of the Licensing Act 2003, it was believed that fixed and artificially early closing times (established under the Licensing Act 1964) were one of the key causes of rapid binge drinking prior to closing times and one of the causes of disorder and disturbance when large number of customers were required to leave the premises simultaneously".

At Paragraph 21.2 it states that "The aim through promotion of the licensing objectives should be to reduce the potential for concentrations and achieve a slower dispersal of people from licensed premises through flexible opening times".

At Paragraph 21.3 it states that "Arbitrary restrictions that would undermine the principle of flexibility will therefore be avoided. The four licensing objectives will be paramount at all times and the Council will always consider the individual merits of each case".

At Paragraph 21.4 it states that "In accordance with guidance there is no fixed restriction on terminal hours for any particular areas of the borough. Such a restriction could cause the migration of patrons from one area to another and create the circumstances that the legislation is attempting to avoid. Each application will be dealt with on its merits. It is for the applicants to detail in their Operating Schedule exactly what times they intend to open and close the premises and what measures they will take to ensure that they do not cause nuisance or disturbance to their neighbours in the vicinity. The later the terminal hour applied for, the greater will be the need to address the issues of disturbance and nuisance".

At Paragraph 21.5 it states that "Shops, stores and supermarkets licensed to sell alcohol will normally be allowed to do so for the full duration of their trading hours. Restrictions may be applied, for example where representations are made indicating the particular premises or patrons of the premises are linked to disorder and or disturbance".

Licence Conditions

At Paragraph 17.1 it states that "Conditions on premises licences and club certificates are determined by:

- a) The measures put forward on the Operating Schedule
- b) Mandatory conditions within the Act
- c) Measures decided at a hearing by the Licensing Sub Committee"

At Paragraph 17.2 it states that "Any conditions attached to licences following relevant representations will focus on matters within the control of the Premises Licence Holder or Club Management Committees. They will address matters which have a direct impact on those living, working or engaged in normal activities in the vicinity, as well as patrons of the licensed premises.

They will not be used as a means of attempting to attach responsibility to Premises Licence Holders or Club Management Committees for matters outside their reasonable control, such as anti-social behaviour once away from the premises or licensable activity".

At Paragraph 17.3 it states that "The Licensing Authority will not impose standard conditions upon every licence issued, however it may have regard to model conditions produced by the Government and/or the Institute of Licensing and it may choose to impose these in appropriate circumstances".

10.0 LEGAL CONSIDERATIONS

LEGAL COMMENTS

1. When considering an application for a grant of a new Premises Licence, the Sub-Committee shall carry out its functions with a view to taking steps it considers appropriate for promoting the licensing objectives. The licensing objectives are:
 - Prevention of crime and disorder
 - Public Safety
 - Prevention of public nuisance
 - Protection of children from harm
2. Members should note that each objective is of equal importance. There are no other licensing objectives, and the four objectives are paramount considerations at all times.
3. The Sub-Committee must ensure that all licensing decisions:
 - Have a direct relationship to the promotion of one or more of the four licensing objectives
 - Have regard to the Council's statement of licensing policy
 - Have regard to the Secretary of State guidance
 - Must not be subject to a blanket policy to the extent that it is applied so rigidly that an exercise of discretion in each individual case is precluded.
4. Relevant representations are those that relate to the effect of the granting of the application on the promotion of the licensing objectives made by an interested party or responsible authority that have not been withdrawn and are not, in the opinion of the relevant licensing authority, frivolous or vexatious s.18(7) Licensing Act 2003.
5. The Sub-Committee can only consider matters within the application that have been raised through representations from interested parties and responsible authorities. Interested parties must live in the vicinity of the premises. This will be decided on a case to case basis.
6. Following a hearing, the Sub-Committee must consider all relevant representations, and having taken into account the promotion of the licensing objectives, under s.18(3)(b) and (4) Licensing Act 2003, a decision can be taken to:
 - I. To grant the licence, subject to the mandatory conditions and conditions consistent with the operating schedule;
 - II. To impose additional relevant conditions to such an extent as is considered necessary for the promotion of the licensing objectives;
 - III. To exclude any of the licensable activities to which the application relates;
 - IV. To amend the times for all or some of the licensable activities;
 - V. To refuse to specify a person in the licence as the premises supervisor
 - VI. To reject the application

7. Conditions will not be necessary if they duplicate a current statutory requirement. The Licensing Authority may therefore only impose such conditions that are necessary to promote the licensing objectives arising out of the consideration of the representations.
8. If the Sub-Committee determines that it is necessary to modify the conditions, or to refuse the application for a Premises Licence application, it must give reasons for its decision.
9. The Council in its capacity as Licensing Authority has a duty to have regard to its public sector equality duty under section 149 of the Equality Act 2010. In summary section 149 provides that a Public Authority must, in the exercise of its functions, have due regard to the need to:
 - i. eliminate discrimination harassment, victimisation and any other conduct that is prohibited by or under this Act;
 - ii. advance equality of opportunity between persons who share a relevant protected characteristic and persons who do not share it; and,
 - iii. foster good relations between persons who share a relevant protected characteristics and persons who do not share it.
10. Section 149 (7) of the Equality Act 2010 defines the relevant protected characteristics as age, disability, gender reassignment, race, religion or belief, sex sexual orientation, marriage and civil partnership and pregnancy and maternity.
11. Interested Parties, Responsible Authorities and the applicant have the right to appeal the decision of the Sub-Committee to the Magistrates' Court within a period of 21days beginning with the day on which the applicant was notified by the licensing authority of the decision to be appealed against.

This page is intentionally left blank

Appendix 1 - Application for the grant of a new premises licence

Application for a premises licence to be granted under the Licensing Act 2003

PLEASE READ THE FOLLOWING INSTRUCTIONS FIRST

Before completing this form please read the guidance notes at the end of the form. If you are completing this form by hand please write legibly in block capitals. In all cases ensure that your answers are inside the boxes and written in black ink. Use additional sheets if necessary.

You may wish to keep a copy of the completed form for your records.

I/We EASTCOTE KARAME LIMITED
(Insert name(s) of applicant)

apply for a premises licence under section 17 of the Licensing Act 2003 for the premises described in Part 1 below (the premises) and I/we are making this application to you as the relevant licensing authority in accordance with section 12 of the Licensing Act 2003

Part 1 - Premises details

Postal address of premises or, if none, ordnance survey map reference or description			
105 FIELD END ROAD EASTCOTE LONDON			
Post town	ALAB LONDON	Postcode	HA5 1QG
Telephone number at premises (if any)		079845 99999	
Non-domestic rateable value of premises		£ 18750.00	

Part 2 - Applicant details

Please state whether you are applying for a premises licence as Please tick as appropriate

- | | |
|---|--|
| <p>a) an individual or individuals *</p> <p>b) a person other than an individual *</p> <p style="margin-left: 20px;">i as a limited company/limited liability partnership</p> <p style="margin-left: 20px;">ii as a partnership (other than limited liability)</p> <p style="margin-left: 20px;">iii as an unincorporated association or</p> <p style="margin-left: 20px;">iv other (for example a statutory corporation)</p> <p>c) a recognised club</p> <p>d) a charity</p> | <p><input type="checkbox"/> please complete section (A)</p> <p><input checked="" type="checkbox"/> please complete section (B)</p> <p><input type="checkbox"/> please complete section (B)</p> <p><input type="checkbox"/> please complete section (B)</p> <p><input type="checkbox"/> please complete section (B)</p> <p><input type="checkbox"/> please complete section (B)</p> <p><input type="checkbox"/> please complete section (B)</p> |
|---|--|

- e) the proprietor of an educational establishment please complete section (B)
- f) a health service body please complete section (B)
- g) a person who is registered under Part 2 of the Care Standards Act 2000 (c14) in respect of an independent hospital in Wales please complete section (B)
- ga) a person who is registered under Chapter 2 of Part 1 of the Health and Social Care Act 2008 (within the meaning of that Part) in an independent hospital in England please complete section (B)
- h) the chief officer of police of a police force in England and Wales please complete section (B)

* If you are applying as a person described in (a) or (b) please confirm (by ticking yes to one box below):

- I am carrying on or proposing to carry on a business which involves the use of the premises for licensable activities; or
- I am making the application pursuant to a statutory function or
- a function discharged by virtue of Her Majesty's prerogative

(A) INDIVIDUAL APPLICANTS (fill in as applicable)

Mr <input type="checkbox"/>		Mrs <input type="checkbox"/>		Miss <input type="checkbox"/>		Ms <input type="checkbox"/>		Other Title (for example, Rev)		
Surname						First names				
Date of birth				I am 18 years old or over <input type="checkbox"/> Please tick yes						
Nationality										
Current residential address if different from premises address										
Post town								Postcode		
Daytime contact telephone number										
E-mail address (optional)										

SECOND INDIVIDUAL APPLICANT (if applicable)

Mr <input type="checkbox"/>		Mrs <input type="checkbox"/>		Miss <input type="checkbox"/>		Ms <input type="checkbox"/>		Other Title (for example, Rev)		
Surname						First names				

Date of birth		I am 18 years old or over <input type="checkbox"/> Please tick yes	
Nationality			
Current postal address if different from premises address			
Post town		Postcode	
Daytime contact telephone number			
E-mail address (optional)			

(B) OTHER APPLICANTS

Please provide name and registered address of applicant in full. Where appropriate please give any registered number. In the case of a partnership or other joint venture (other than a body corporate), please give the name and address of each party concerned.

Name	EASTCOTE KAZAMI LIMITED
Address	71 - 75 SHELDON STREET COVENT GARDEN LONDON WC2M 9JG
Registered number (where applicable)	11559273
Description of applicant (for example, partnership, company, unincorporated association etc.)	Company
Telephone number (if any)	
E-mail address (optional)	

Part 3 Operating Schedule

When do you want the premises licence to start?

DD MM YYYY
01 07 2019

If you wish the licence to be valid only for a limited period, when do you want it to end?

N/A

DD	MM	YYYY

Please give a general description of the premises (please read guidance note 1)

The premises is a ground floor restaurant on Field End Road situated in between a parade of shops

If 5,000 or more people are expected to attend the premises at any one time, please state the number expected to attend.

N/A

What licensable activities do you intend to carry on from the premises?

(please see sections 1 and 14 and Schedules 1 and 2 to the Licensing Act 2003)

Provision of regulated entertainment (please read guidance note 2)

Please tick all that apply

- a) plays (if ticking yes, fill in box A)
- b) films (if ticking yes, fill in box B)
- c) indoor sporting events (if ticking yes, fill in box C)
- d) boxing or wrestling entertainment (if ticking yes, fill in box D)
- e) live music (if ticking yes, fill in box E)
- f) recorded music (if ticking yes, fill in box F)
- g) performances of dance (if ticking yes, fill in box G)
- h) anything of a similar description to that falling within (e), (f) or (g) (if ticking yes, fill in box H)

Provision of late night refreshment (if ticking yes, fill in box I)



Supply of alcohol (if ticking yes, fill in box J)



In all cases complete boxes K, L and M

A

Plays Standard days and timings (please read guidance note 7)			<u>Will the performance of a play take place indoors or outdoors or both – please tick</u> (please read guidance note 3)	Indoors	<input type="checkbox"/>
Day	Start	Finish		Outdoors	<input type="checkbox"/>
Mon				Both	<input type="checkbox"/>
Tue				<u>Please give further details here</u> (please read guidance note 4)	
Wed					
Thur			<u>State any seasonal variations for performing plays</u> (please read guidance note 5)		
Fri					
Sat			<u>Non standard timings. Where you intend to use the premises for the performance of plays at different times to those listed in the column on the left, please list</u> (please read guidance note 6)		
Sun					

B

Films Standard days and timings (please read guidance note 7)			Will the exhibition of films take place indoors or outdoors or both – please tick (please read guidance note 3)	
			Indoors	<input type="checkbox"/>
			Outdoors	<input type="checkbox"/>
			Both	<input type="checkbox"/>
Day	Start	Finish	Please give further details here (please read guidance note 4)	
Mon				
Tue			State any seasonal variations for the exhibition of films (please read guidance note 5)	
Wed				
Thur				
Fri			Non standard timings. Where you intend to use the premises for the exhibition of films at different times to those listed in the column on the left, please list (please read guidance note 6)	
Sat				
Sun				

C

Indoor sporting events Standard days and timings (please read guidance note 7)			Please give further details (please read guidance note 4)
Day	Start	Finish	
Mon			
Tue			State any seasonal variations for indoor sporting events (please read guidance note 5)
Wed			
Thur			Non standard timings. Where you intend to use the premises for indoor sporting events at different times to those listed in the column on the left, please list (please read guidance note 6)
Fri			
Sat			
Sun			

D

Boxing or wrestling entertainments Standard days and timings (please read guidance note 7)			Will the boxing or wrestling entertainment take place indoors or outdoors or both – please tick (please read guidance note 3)	Indoors	<input type="checkbox"/>
				Outdoors	<input type="checkbox"/>
Both	<input type="checkbox"/>				
Day	Start	Finish	Please give further details here (please read guidance note 4)		
Mon					
Tue			State any seasonal variations for boxing or wrestling entertainment (please read guidance note 5)		
Wed					
Thur			Non standard timings. Where you intend to use the premises for boxing or wrestling entertainment at different times to those listed in the column on the left, please list (please read guidance note 6)		
Fri					
Sat					
Sun					

E

Live music Standard days and timings (please read guidance note 7)			<u>Will the performance of live music take place indoors or outdoors or both – please tick</u> (please read guidance note 3)	Indoors	<input type="checkbox"/>
Day	Start	Finish		Outdoors	<input type="checkbox"/>
Mon			<u>Please give further details here</u> (please read guidance note 4)	Both	<input type="checkbox"/>
Tue					
Wed					
Thur			<u>State any seasonal variations for the performance of live music</u> (please read guidance note 5)		
Fri					
Sat					
Sun			<u>Non standard timings. Where you intend to use the premises for the performance of live music at different times to those listed in the column on the left, please list</u> (please read guidance note 6)		

F

Recorded music Standard days and timings (please read guidance note 7)			Will the playing of recorded music take place <u>indoors or outdoors or both</u> – please tick (please read guidance note 3)	Indoors	<input checked="" type="checkbox"/>
Day	Start	Finish		Outdoors	<input type="checkbox"/>
Mon	18.00	01.00	Please give further details here (please read guidance note 4) recorded music at low volume for dance.	Both	<input type="checkbox"/>
Tue	18.00	1.00am			
Wed	18.00	1.00am	State any seasonal variations for the playing of recorded music (please read guidance note 5)		
Thur	18.00	1.00am			
Fri	18.00	10.30pm	Non standard timings. Where you intend to use the premises for the playing of recorded music at different times to those listed in the column on the left, please list (please read guidance note 6)		
Sat	18.00	1.00am 1.30am			
Sun	18.00	midnight			

G

Performances of dance Standard days and timings (please read guidance note 7)			Will the performance of dance take place <u>indoors or outdoors or both</u> – please tick (please read guidance note 3)	Indoors	<input type="checkbox"/>
Day	Start	Finish		Outdoors	<input type="checkbox"/>
Mon				Both	<input type="checkbox"/>
Tue				Please give further details here (please read guidance note 4)	
Wed					
Thur			State any seasonal variations for the performance of dance (please read guidance note 5)		
Fri					
Sat			Non standard timings. Where you intend to use the premises for the performance of dance at different times to those listed in the column on the left, please list (please read guidance note 6)		
Sun					

H

<p>Anything of a similar description to that falling within (e), (f) or (g) Standard days and timings (please read guidance note 7)</p>			<p>Please give a description of the type of entertainment you will be providing</p>		
Day	Start	Finish	<p><u>Will this entertainment take place indoors or outdoors or both – please tick</u> (please read guidance note 3)</p>	Indoors	<input type="checkbox"/>
Mon				Outdoors	<input type="checkbox"/>
				Both	<input type="checkbox"/>
Tue			<p><u>Please give further details here</u> (please read guidance note 4)</p>		
Wed					
Thur			<p><u>State any seasonal variations for entertainment of a similar description to that falling within (e), (f) or (g)</u> (please read guidance note 5)</p>		
Fri					
Sat			<p><u>Non standard timings. Where you intend to use the premises for the entertainment of a similar description to that falling within (e), (f) or (g) at different times to those listed in the column on the left, please list</u> (please read guidance note 6)</p>		
Sun					

I

Late night refreshment Standard days and timings (please read guidance note 7)			Will the provision of late night refreshment take place indoors or outdoors or both – please tick (please read guidance note 3)	Indoors	<input checked="" type="checkbox"/>
Day	Start	Finish		Outdoors	<input type="checkbox"/>
Mon	11pm 23.00	1am	Please give further details here (please read guidance note 4)	Both	<input type="checkbox"/>
Tue	11pm 23.00	1am			
Wed	11pm 23.00	1am	State any seasonal variations for the provision of late night refreshment (please read guidance note 5)		
Thu	11pm 23.00	1am			
Fri	11pm 23.00	1.30am	Non standard timings. Where you intend to use the premises for the provision of late night refreshment at different times, to those listed in the column on the left, please list (please read guidance note 6)		
Sat	11pm 23.00	1.30am			
Sun	11pm 23.00	midnight			

J

Supply of alcohol Standard days and timings (please read guidance note 7)			Will the supply of alcohol be for consumption - please tick (please read guidance note 8)	On the premises <input checked="" type="checkbox"/>
				Off the premises <input type="checkbox"/>
				Both <input type="checkbox"/>
Day	Start	Finish	State any seasonal variations for the supply of alcohol (please read guidance note 5)	
Mon	noon	1 AM		
Tue	noon	1 AM		
Wed	noon	1 AM		
Thur	noon	1 AM		
Fri	noon	1 AM		
Sat	noon	1 AM		
Sun	noon	midnight		
			Non standard timings. Where you intend to use the premises for the supply of alcohol at different times to those listed in the column on the left, please list (please read guidance note 6)	

State the name and details of the individual whom you wish to specify on the licence as designated premises supervisor (Please see declaration about the entitlement to work in the checklist at the end of the form):

Name	
Date of birth	
Address Please note initially alcohol will not be sold at the premises, prior to alcohol being sold at a DPS will be arranged.	
Postcode	
Personal licence number (if known)	
Issuing licensing authority (if known)	

□□□□

K

Please highlight any adult entertainment or services, activities, other entertainment or matters ancillary to the use of the premises that may give rise to concern in respect of children (please read guidance note 9).

None.

L

Hours premises are open to the public Standard days and timings (please read guidance note 7)			State any seasonal variations (please read guidance note 5)
Day	Start	Finish	
Mon	noon	1 Am	
Tue	noon	1 Am	
Wed	noon	1 Am	
Thur	noon	11:55 PM	
Fri	noon	1.50 am	
Sat	noon	1.30 am	
Sun	noon	midnight	

Non standard timings. Where you intend the premises to be open to the public at different times from those listed in the column on the left, please list (please read guidance note 6)

M Describe the steps you intend to take to promote the four licensing objectives:

a) General - all four licensing objectives (b, c, d and e) (please read guidance note 10)

alcohol only to be sold
with table meals.

b) The prevention of crime and disorder

- CCTV system should be installed & maintained in effective working order
- premises to be well lit from inside & outside
- The alcohol will not be accessible to members of the public.

c) Public safety

- a fire alarm system to be installed
- staff shall be trained in respect of evacuation procedure
- It is anticipated there will be 5 fire extinguishers (2 in front, 2 in rear + 1 in kitchen) + fire blanket in kitchen but this is subject to change

d) The prevention of public nuisance

All music to be kept to a reasonable level
All refuse shall be kept in waste containers

e) The protection of children from harm

A recognised proof of eye scheme shall be implemented and the challenge 25 scheme will be actuated.

Checklist:

Please tick to indicate agreement

- I have made or enclosed payment of the fee.
- I have enclosed the plan of the premises.
- I have sent copies of this application and the plan to responsible authorities and others where applicable.
- I have enclosed the consent form completed by the individual I wish to be designated premises supervisor, if applicable.
- I understand that I must now advertise my application.
- I understand that if I do not comply with the above requirements my application will be rejected.
- [Applicable to all individual applicants, including those in a partnership which is not a limited liability partnership, but not companies or limited liability partnerships] I have included documents demonstrating my entitlement to work in the United Kingdom (please read note 15).

IT IS AN OFFENCE, UNDER SECTION 158 OF THE LICENSING ACT 2003, TO MAKE A FALSE STATEMENT IN OR IN CONNECTION WITH THIS APPLICATION. THOSE WHO MAKE A FALSE STATEMENT MAY BE LIABLE ON SUMMARY CONVICTION TO A FINE OF ANY AMOUNT.

IT IS AN OFFENCE UNDER SECTION 24B OF THE IMMIGRATION ACT 1971 FOR A PERSON TO WORK WHEN THEY KNOW, OR HAVE REASONABLE CAUSE TO BELIEVE, THAT THEY ARE DISQUALIFIED FROM DOING SO BY REASON OF THEIR IMMIGRATION STATUS. THOSE WHO EMPLOY AN ADULT WITHOUT LEAVE OR WHO IS SUBJECT TO CONDITIONS AS TO EMPLOYMENT WILL BE LIABLE TO A CIVIL PENALTY UNDER SECTION 15 OF THE IMMIGRATION, ASYLUM AND NATIONALITY ACT 2006 AND PURSUANT TO SECTION 21 OF THE SAME ACT, WILL BE COMMITTING AN OFFENCE WHERE THEY DO SO IN THE KNOWLEDGE, OR WITH REASONABLE CAUSE TO BELIEVE, THAT THE EMPLOYEE IS DISQUALIFIED.

Part 4 – Signatures (please read guidance note 11)

Signature of applicant or applicant’s solicitor or other duly authorised agent (see guidance note 12). If signing on behalf of the applicant, please state in what capacity.

Declaration	<ul style="list-style-type: none"> [Applicable to individual applicants only, including those in a partnership which is not a limited liability partnership] I understand I am not entitled to be issued with a licence if I do not have the entitlement to live and work in the UK (or if I am subject to a condition preventing me from doing work relating to the carrying on of a licensable activity) and that my licence will become invalid if I cease to be entitled to live and work in the UK (please read guidance note 15). The DPS named in this application form is entitled to work in the UK (and is not subject to conditions preventing him or her from doing work relating to a licensable activity) and I have seen a copy of his or her proof of entitlement to work, if appropriate (please see note 15)
Signature	
Date	29/5/19
Capacity	DIRECTOR

For joint applications, signature of 2nd applicant or 2nd applicant's solicitor or other authorised agent (please read guidance note 13). If signing on behalf of the applicant, please state in what capacity.

Signature	
Date	
Capacity	

Contact name (where not previously given) and postal address for correspondence associated with this application (please read guidance note 14)			
Post town		Postcode	
Telephone number (if any)			
If you would prefer us to correspond with you by e-mail, your e-mail address (optional)			

Notes for Guidance

- Describe the premises, for example the type of premises, its general situation and layout and any other information which could be relevant to the licensing objectives. Where your application includes off-supplies of alcohol and you intend to provide a place for consumption of these off-supplies, you must include a description of where the place will be and its proximity to the premises.
- In terms of specific regulated entertainments please note that:

Legend:



Fire escape sign to BS 5499 (see example below)

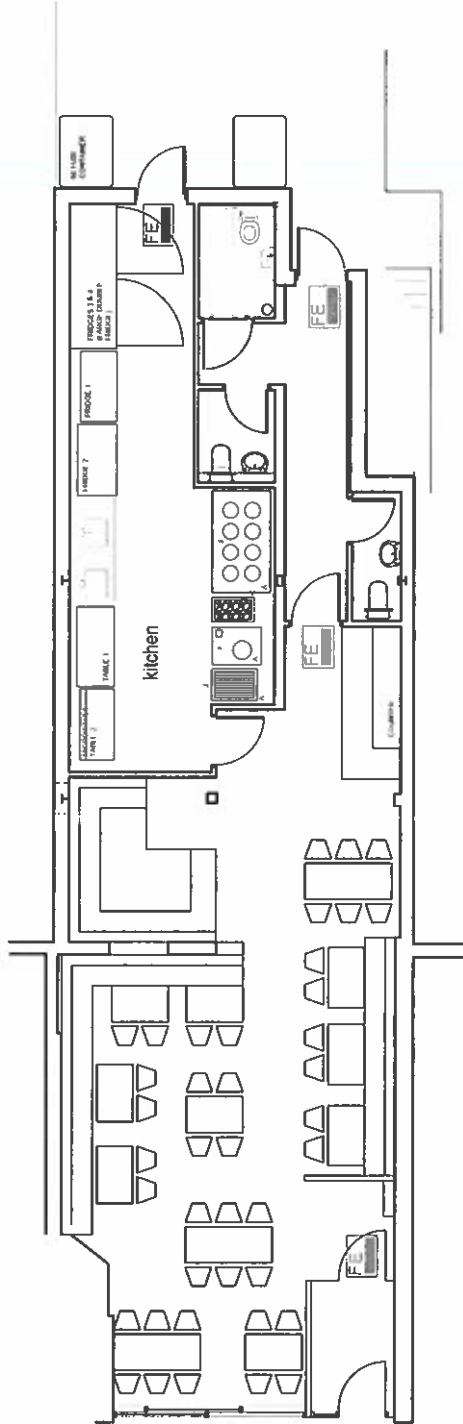

© copyright reserved

A3 @	Date	Job No.	Drg. No.
1 : 100	19.09.18	A3626	L001/P2
www.argent-architects.co.uk ARGENT ARCHITECTS info@arg-architects.co.uk			
Ltd 01832 845440 Ltd 01832 845440			



Project Address: 105 Field End Road, Eastcote		Rev	Description	Date
Project Name: Eastcote Karahi		P1	Issued to client	31.05.19
SHEET NAME: Floor plan showing fire exits		P2	Issued to client	10.06.19

Appendix 2 - Summary of amendments to application

Withdraw the part of the application for recorded music and reduce the terminal hour for late night refreshment, sale of alcohol and opening hours to midnight Sunday to Thursday and 1.00am on Friday and Saturday.

Re - word existing conditions:

Prevention of crime and disorder

The installed CCTV system shall be maintained in effective working order at all times. The CCTV system shall retain all recordings for a minimum of 31 days and shall contain the correct date and time of the image capture. Recordings shall be made available immediately upon request to the Police and/or authorised officers of the London Borough of Hillingdon.

Protection of children from harm

A Challenge 25 scheme shall be operated at the premises. Only photographic ID shall be acceptable as proof of age (passport, photo driving licence, or PASS card).

Add following conditions:

The prevention of public nuisance

No noise shall emanate from the premises nor vibration be transmitted through the structure of the premises that gives rise to a nuisance.

The external back door shall be kept closed between 19.00 hours and closing, except for the immediate access and egress of persons.

Notices shall be prominently displayed near the entrance and exit doors requesting patrons to respect the needs of local residents and leave the area quietly.

Staff shall monitor customers smoking outside the premises on a regular basis to ensure patrons do not cause a public nuisance.

Protection of children from harm

Staff shall be trained in responsible alcohol retailing. Staff training records shall be made available for inspection upon request by officers of a Responsible Authority

This page is intentionally left blank

Appendix 3 - Representation from local resident, Paul Faith
Representation Form from Interested Parties
(Please read notes on reverse before completing)

26 JUN 2019

Your details (See notes 2 & 3);

Your Name	<u>Paul Faith</u>
Your residential address	
Your email address	
Your phone number	
The name of the body or organisation you represent	<u>Resident</u>

About the premises;

Name of the premises you are making a representation about	<u>Eastcote Karami Ltd</u>
Address of the premises you are making a representation about	<u>105 Field End Road, Eastcote</u>

The Licensing Objectives (See note 4);

Licensing Objective	Reasons for your representation and any supporting evidence
<p><i>Please tick;</i></p> <p><input type="checkbox"/> Prevention of Crime/Disorder</p> <p><input checked="" type="checkbox"/> Prevention of Public Nuisance</p> <p><input checked="" type="checkbox"/> Protection of Children From Harm</p> <p><input type="checkbox"/> Public Safety</p>	<p><u>Late night drinking and noise for local residents will affect adults and children who live in the residential block directly above the restaurant.</u></p>

The outcome you are seeking from the Licensing Authority (See note 6);

<p><u>Not to issue a music licence</u></p> <p><u>Limit the alcohol licence until 11pm</u></p>

Signed:

Date: 25/06/2019

This page is intentionally left blank

Appendix 4 - Representation from local resident, Caren Westhead

Representation Form from Interested Parties

(Please read notes on reverse before completing)

Your details (See notes 2 & 3);

Your Name	CAREN and (SON) Matthew Westhead
Your residential address	
Your email address	
Your phone number	
The name of the body or organisation you represent	

About the premises;

Name of the premises you are making a representation about	Eastcote Karahi
Address of the premises you are making a representation about	105 Field End Rd

The Licensing Objectives (See note 4);

Licensing Objective	Reasons for your representation and any supporting evidence
<p>Please tick;</p> <p><input checked="" type="checkbox"/> Prevention of Crime/ Disorder</p> <p><input checked="" type="checkbox"/> Prevention of Public Nuisance</p> <p><input type="checkbox"/> Protection of Children From Harm</p> <p><input type="checkbox"/> Public Safety</p>	<p>We have their fans and extractor for their kitchens directly placed outside our rear bedroom windows. This will be a nuisance from noise and vibrations, noxious smells directly into our bedrooms. (I am not certain any permissions have been sought to place them there so close) needs to be investigated. Late night licensing will therefore keep us awake and this is unacceptable. They will be ^{noise} outside at the rear from the kitchens working ^{late}. The noise from their kitchens will also be detrimental to our health and not with them washing dishes, chatting as the alcohol licensing, we feel would be abused as it is currently a concern that when groups get together. In this case (male visitors) drinking and hanging around causing a nuisance occurs daily</p>

The outcome you are seeking from the Licensing Authority (See note 6);

<p>NO LATE NIGHT License</p> <p>NO ALCOHOL License</p>	<p>by neighbouring restaurant late noise with cars pulling up, litter, hanging around till 2am after it closes at midnight this has to stop. We already have drugs in the area. Big groups is unsafe</p>
---	--

Signed: ...

Date:

25/1/19

Dear Licensing Dept

Please find attached Objections
to Eastore ~~E~~ Karahi's application
for late license and alcohol.

Kind

Regards

Caren Westhead



licensing . <licensing@hillington.gov.uk>

Re: Scan from a Samsung MFP

1 message

Caren Westhead

2 July 2019 at 10:32

To: "licensing ." <licensing@hillington.gov.uk>

Mark

Thanks for clarifying, sorry about my rushed message on my phone, typing on the phone, Thanks also for contact numbers. I am a nurse and have lived here for 10 years now so This is will be an issue for me. I work all days of the week with 12 hour shifts. How can this restaurant /bar/club reassure this will not affect me.

My son is a carpenter/builder. He too has to be up very early and travel all over London.

They have not consulted myself or neighbours in any discussion, they went ahead and placed the ventilation systems above his shop, I do not understand how he was able to just do this without any thought or consideration of others.

From my experience they are unlikely to keep their back doors closed from 7.30 in the evenings, the kitchen noise will be disruptive especially the late hours, LaHore evidence this every time. They don't consider the flats are immediately above, and not built for the purpose of clubs/restaurants scenes.

I am grateful for your uptodate information.

Kind regards

Care

So my lease deems that I am permitted to live in pleace and quiet without disturbance.

Sent from Yahoo Mail for iPad

On Tuesday, July 2, 2019, 10:05 am, licensing . <licensing@hillington.gov.uk> wrote:

Dear Caren,

Thanks for getting back to me and clarifying. The installation of extractors are dealt with under planning and you need to contact Planning Services regarding this Tel no. 01895 250230 email planning@hillington.gov.uk.

Also with regard to you and your sons objection, we cannot attribute general anti social problems to the applicant and he is not responsible for the patrons of other premises but i do understand that this adds to general public nuisance in the area and demonstrable harm linked to this premises will need to be based upon the evidence. For your information we have a provisional committee hearing date of 30/7/2019.

Kind regards,

Mark

On Mon, 1 Jul 2019 at 18:33, Carenwesthead

wrote:

Hi thanks however i would still dispute this. They have vents and fans and kitchens at the rear which would be disruptive at weekends I work shifts and this includes weekends. Our bedrooms at the rear will mean continous distrupction weekdays and worse so at weekends. I will dispute this again.
Thanks

Sent from my iPhone

On 1 Jul 2019, at 11:22, licensing . <licensing@hillingdon.gov.uk> wrote:

Hi

Further to consultation between myself and the applicant following concerns raised by residents the applicant has decide to amend the application as follows that may allay your concerns:

Withdraw the part of the application for recorded music and reduce the terminal hour for late night refreshment, sale of alcohol and opening hours to midnight Sunday to Thursday and 1.00am on Friday and Saturday.

Re - word existing conditions:

Prevention of crime and disorder

The installed CCTV system shall be maintained in effective working order at all times. The CCTV system shall retain all recordings for a minimum of 31 days and shall contain the correct date and time of the image capture. Recordings shall be made available immediately upon request to the Police and/or authorised officers of the London Borough of Hillingdon.

Protection of children from harm

A Challenge 25 scheme shall be operated at the premises. Only photographic ID shall be acceptable as proof of age (passport, photo driving licence, or PASS card).

Add following conditions:

The prevention of public nuisance

No noise shall emanate from the premises nor vibration be transmitted through the structure of the premises that gives rise to a nuisance.

The external back door shall be kept closed between 19.00 hours and [closing] hours, except for the immediate access and egress of persons.

Notices shall be prominently displayed near the entrance and exit doors requesting patrons to respect the needs of local residents and leave the area quietly.

Staff shall monitor customers smoking outside the premises on a regular basis to ensure patrons do not cause a public nuisance.

Protection of children from harm

Staff shall be trained in responsible alcohol retailing. Staff training records shall be made available for inspection upon request by officers of a Responsible Authority

On Sat, 29 Jun 2019 at 17:19,

wrote:

Disclaimer

This message contains information that may be privileged or confidential and is intended only for the person to whom it is addressed. Any views or opinions presented are solely those of the author and do not necessarily represent those of Care UK. If you are not the intended recipient, you are not authorised to read, print, retain, copy, disseminate, distribute, or use this message or any part of this message. If you receive this message in error, please notify us immediately by emailing IT.Security @ careuk.com and deleting all copies of this message. Care UK filters and monitors all Internet communications.

Care UK is registered and incorporated in England under company registration
Page 42

**Appendix 5 - Representation from local resident,
Matthew Westhead**

Representation Form from Interested Parties

(Please read notes on reverse before completing)

Your details (See notes 2 & 3);

Your Name	Matthew Westhead
Your residential address	
Your email address	
Your phone number	
The name of the body or organisation you represent	NIL

About the premises;

Name of the premises you are making a representation about	Eastgate Karahi
Address of the premises you are making a representation about	105 Field End Rd

The Licensing Objectives (See note 4);

Licensing Objective	Reasons for your representation and any supporting evidence
<p>Please tick;</p> <p><input checked="" type="checkbox"/> Prevention of Crime/ Disorder</p> <p><input checked="" type="checkbox"/> Prevention of Public Nuisance (1)</p> <p><input type="checkbox"/> Protection of Children From Harm</p> <p><input checked="" type="checkbox"/> Public Safety (1)</p>	<p>Drugs are are being sold locally, alcohol and Late Night Licensing will make the area further unsafe for everyone.</p> <p>I sleep above the premises and work shifts. This will affect me personally.</p> <p>We already have problems with Lahore and their mainly male clientele standing outside after midnight.</p> <p>They don't finish when they should and go home. They have to stand and be rowdy outside for another hour sometimes 2am in the morning. Air con +</p>

The Fans of their cooking are going on and on and on + on

The outcome you are seeking from the Licensing Authority (See note 6); IF late night

<p><u>No Alcohol License</u></p> <p><u>No Late night License.</u></p>	<p>Licenses is agreed since they are situated them outside my flat window.</p>
---	--

Noxious Smells, Light Pollution all these things will affect us.

Signed:

..... Date: 28/6/19.....

This page is intentionally left blank

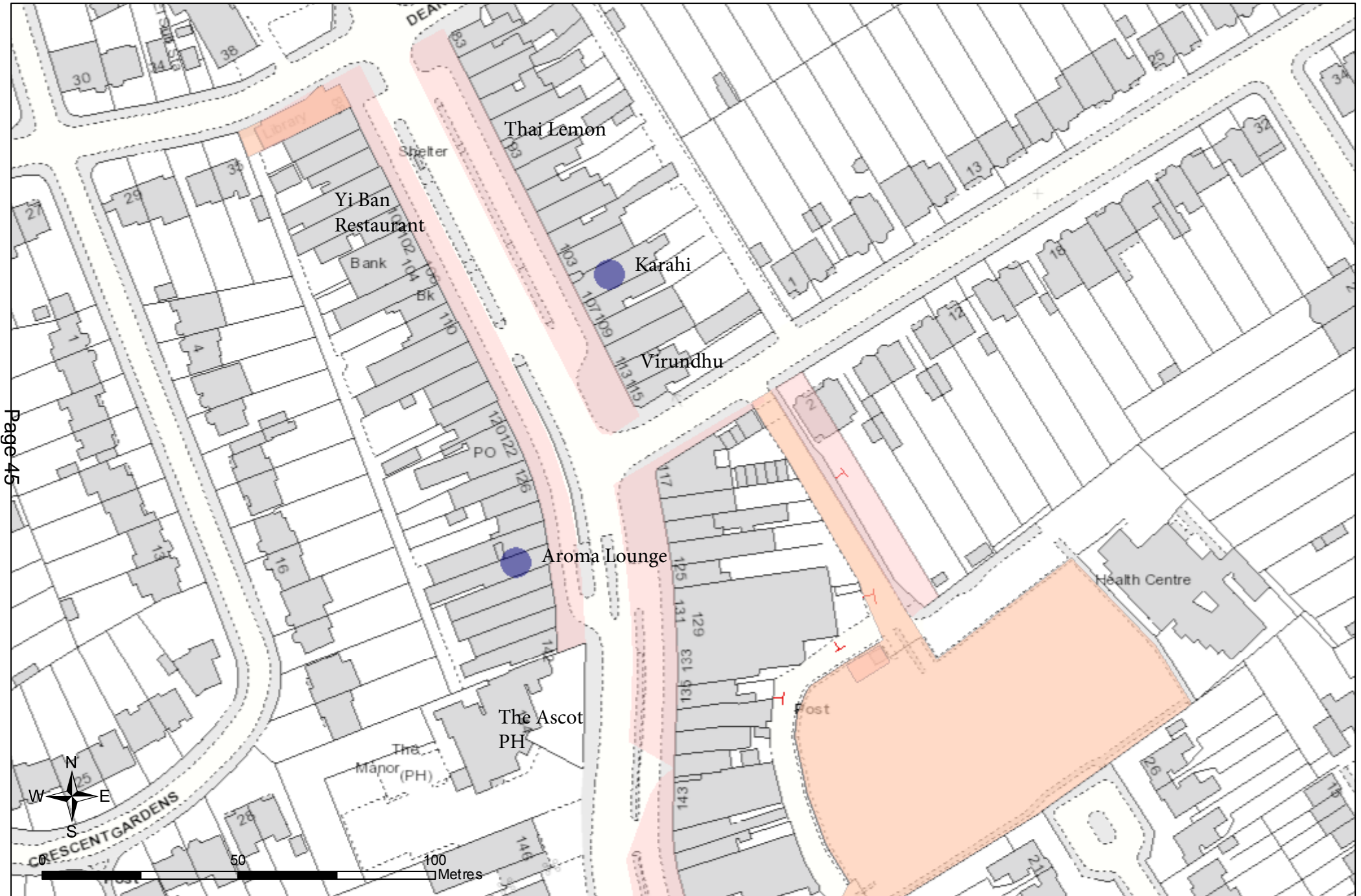

This page is intentionally left blank

Appendix 7 - Photo of the premises



This page is intentionally left blank

LICENSING ACT 2003
Section 24



HILLINGDON
 LONDON

PREMISES LICENCE

Surrendered 19/11/2018

Ref: SG/45/LBH

Premises Licence Number: 94/05

This Premises Licence has been issued by Norman C Stanley on behalf of the Licensing Authority, London Borough of Hillingdon, Civic Centre, High Street, Uxbridge, UB8 1UW

Signature: Date: 9th January 2009

Part 1 – Premises Details

Postal Address of Premises or, if none, Ordnance Survey map reference or description -
 Ortenzi Restaurant
 105 Field End Road

Post Town - Eastcote

Postcode - HA5 1QG

Telephone number - 020 8429 0323

Where the licence is time limited, the dates –

N/A

Licensable activities authorised by the licence -

Sale by retail of alcohol

Recorded music

The provision of entertainment facilities for making music, dancing and entertainment of a similar description for private functions.

Provision of late night refreshment

The times the licence authorises the carrying out of licensable activities –

The sale of alcohol by retail

On weekdays, other than Christmas Day, Good Friday or New Year's Eve, between 10.00 and 24.00 hours.

On Sundays, Christmas Day and on Good Friday, between 12.00 and 23.30 hours.

In addition to the hours detailed above from the start of licensed hours on New Year's Eve to the start of licensed hours on New Year's Day.

Late night refreshment

From 23.00 to 30 minutes after the terminal time for the sale of alcohol

The provision of recorded music is not time restricted

The provision of entertainment facilities for making music, dancing and entertainment of a similar description is not time limited for the purpose of private functions.

The opening hours of the premises -

Not Restricted

Where the licence authorises supplies of alcohol whether these are on and/or off supplies -

On supplies only

Part 2

Name, (registered) address, telephone number and e-mail (where relevant) of holder of Premises Licence -

Registered number of holder, for example company number, charity number (where applicable) -

N/A

Name, address and telephone number of designated premises supervisor where the premises licence authorises the supply of alcohol –

Personal Licence number an issuing authority of personal licence held by designated premises supervisor where the premises licence authorises for the supply of alcohol –

Annex 1 – Mandatory Conditions

Alcohol

1. No sale/supply of alcohol shall be made when there is no Designated Premises Supervisor in respect of the premises licence
2. No sale/supply of alcohol shall be made when the Designated Premises Supervisor does not hold a Personal Licence or when his/her Personal Licence is suspended
3. Every sale/supply of alcohol under the premises licence shall be made, or authorised, by a person who holds a Personal Licence

Applicable from 6th April 2010

1. (1) The responsible person shall take all reasonable steps to ensure that staff on relevant premises do not carry out, arrange or participate in any irresponsible promotions in relation to the premises.

(2) In this paragraph, an irresponsible promotion means any one or more of the following activities, or substantially similar activities, carried on for the purpose of encouraging the sale or supply of alcohol for consumption on the premises in a manner which carries a significant risk of leading or contributing to crime and disorder, prejudice to public safety, public nuisance, or harm to children—

(a) games or other activities which require or encourage, or are designed to require or encourage, individuals to—

(i) drink a quantity of alcohol within a time limit (other than to drink alcohol sold or supplied on the premises before the cessation of the period in which the responsible person is authorised to sell or supply alcohol), or

(ii) drink as much alcohol as possible (whether within a time limit or otherwise);

(b) provision of unlimited or unspecified quantities of alcohol free or for a fixed or discounted fee to the public or to a group defined by a particular characteristic (other than any promotion or discount available to an individual in respect of alcohol for consumption at a table meal, as defined in section 159 of the Act);

(c) provision of free or discounted alcohol or any other thing as a prize to encourage or reward the purchase and consumption of alcohol over a period of 24 hours or less;

(d) provision of free or discounted alcohol in relation to the viewing on the premises of a sporting event, where that provision is dependent on—

(i) the outcome of a race, competition or other event or process, or

(ii) the likelihood of anything occurring or not occurring;

(e) selling or supplying alcohol in association with promotional posters or flyers on, or in the vicinity of, the premises which can reasonably be considered to condone, encourage or glamorise anti-social behaviour or to refer to the effects of drunkenness in any favourable manner.

2. The responsible person shall ensure that no alcohol is dispensed directly by one person into the mouth of another person where that other person is unable to

drink without assistance by reason of a disability).

3. The responsible person shall ensure that free tap water is provided on request to customers where it is reasonably available.

Applicable from 1st October 2010

4. (1) The premises licence holder or club premises certificate holder shall ensure that an age verification policy applies to the premises in relation to the sale or supply of alcohol.

(2) The policy must require individuals who appear to the responsible person to be under 18 years of age (or such older age as may be specified in the policy) to produce on request, before being served alcohol, identification bearing their photograph, date of birth and a holographic mark.

5. The responsible person shall ensure that—
 - (a) where any of the following alcoholic drinks is sold or supplied for consumption on the premises (other than alcoholic drinks sold or supplied having been made up in advance ready for sale or supply in a securely closed container) it is available to customers in the following measures—
 - (i) beer or cider: ½ pint;
 - (ii) gin, rum, vodka or whisky: 25 ml or 35 ml; and
 - (iii) still wine in a glass: 125 ml; and

(b) customers are made aware of the availability of these measures.

Annex 2– Conditions consistent with the operating Schedule

The Licence Holder shall ensure that the following licence conditions are fully complied with:

Alcohol shall only be sold to persons taking table meals in the premises and when ancillary to the meal

All exit/ entrance doors shall remain unlocked when the premises are open to the public

The maximum number of persons in the premises shall not exceed 40.

Annex 3 – Conditions attached after a hearing by the licensing authority

N/A

Annex 4 – Plans

Ortenzi Restaurant

The licensed areas of the premises as detailed on the drawing annexed hereto :-

Plan number LBH 105/05

Dimensions Group Drawing Number 0003008

This page is intentionally left blank