

London Borough of Hillingdon Licensing Authority

**Application for a premises licence to be granted
under the Licensing Act 2003**

PLEASE READ THE FOLLOWING INSTRUCTIONS FIRST

Before completing this form please read the guidance notes at the end of the form. If you are completing this form by hand please write legibly in block capitals. In all cases ensure that your answers are inside the boxes and written in black ink. Use additional sheets if necessary.

You may wish to keep a copy of the completed form for your records.

I/We Ivy Leaf Club Uxbridge Limited

(Insert name(s) of applicant)

apply for a premises licence under section 17 of the Licensing Act 2003 for the premises described in Part 1 below (the premises) and I/we are making this application to you as the relevant licensing authority in accordance with section 12 of the Licensing Act 2003

Part 1 – Premises Details

Postal address of premises or, if none, ordnance survey map reference or description			
Ground Floor Ivy Leaf Club Uxbridge Limited 8 Wellington Road			
Post town	Uxbridge		UB8 2AP
Telephone number at premises (if any)		01895 232723	
Non-domestic rateable value of premises		£9,900	

Part 2 - Applicant Details

Please state whether you are applying for a premises licence as

Please tick as appropriate

- | | | |
|---|-------------------------------------|-----------------------------|
| a) an individual or individuals * | <input type="checkbox"/> | please complete section (A) |
| b) a person other than an individual * | | |
| i. as a limited company | <input checked="" type="checkbox"/> | please complete section (B) |
| ii. as a partnership | <input type="checkbox"/> | please complete section (B) |
| iii. as an unincorporated association or | <input type="checkbox"/> | please complete section (B) |
| iv. other (for example a statutory corporation) | <input type="checkbox"/> | please complete section (B) |

- c) a recognised club please complete section (B)
- d) a charity please complete section (B)
- e) the proprietor of an educational establishment please complete section (B)
- f) a health service body please complete section (B)
- g) a person who is registered under Part 2 of the Care Standards Act 2000 (c14) in respect of an independent hospital in Wales please complete section (B)
- ga) a person who is registered under Chapter 2 of Part 1 of the Health and Social Care Act 2008 (within the meaning of that Part) in an independent hospital in England please complete section (B)
- h) the chief officer of police of a police force in England and Wales please complete section (B)

* If you are applying as a person described in (a) or (b) please confirm:

Please tick yes

I am carrying on or proposing to carry on a business which involves the use of the premises for licensable activities; or

I am making the application pursuant to a
 statutory function or
 a function discharged by virtue of Her Majesty's prerogative

(A) INDIVIDUAL APPLICANTS (fill in as applicable)

Mr <input type="checkbox"/>	Mrs <input type="checkbox"/>	Miss <input type="checkbox"/>	Ms <input type="checkbox"/>	Other Title (for example, Rev)	
Surname			First names		
I am 18 years old or over				<input type="checkbox"/>	Please tick yes
Current postal address if different from premises address					
Post town			Postcode		
Daytime contact telephone number					
E-mail address (optional)					

SECOND INDIVIDUAL APPLICANT (if applicable)

Mr <input type="checkbox"/>	Mrs <input type="checkbox"/>	Miss <input type="checkbox"/>	Ms <input type="checkbox"/>	Other Title (for example, Rev)	
Surname			First names		
I am 18 years old or over					<input type="checkbox"/> Please tick yes
Current postal address if different from premises address					
Post town				Postcode	
Daytime contact telephone number					
E-mail address (optional)					

(B) OTHER APPLICANTS

Please provide name and registered address of applicant in full. Where appropriate please give any registered number. In the case of a partnership or other joint venture (other than a body corporate), please give the name and address of each party concerned.

Name Ivy Leaf Club (Uxbridge) Limited
Address 8 Wellington Road Uxbridge UB8 2AP
Registered number (where applicable) IP08275R
Description of applicant (for example, partnership, company, unincorporated association etc.) Private Limited Company
Telephone number (if any)
E-mail address (optional)

Part 3 Operating Schedule

When do you want the premises licence to start?

01	01	2016
0	1	0 01 22 0 1 6

If you wish the licence to be valid only for a limited period, when do you want it to end?

DD	MM	YYYY

Please give a general description of the premises (please read guidance note 1)

Private Members Club

Existing Club Premises Certificate ref LBHIL 09/05C

Application for New Premises Licence limited to ground floor only

If 5,000 or more people are expected to attend the premises at any one time, please state the number expected to attend.

What licensable activities do you intend to carry on from the premises?

(Please see sections 1 and 14 of the Licensing Act 2003 and Schedules 1 and 2 to the Licensing Act 2003)

Provision of regulated entertainment

Please tick any that apply

- | | |
|---|-------------------------------------|
| a) plays (if ticking yes, fill in box A) | <input type="checkbox"/> |
| b) films (if ticking yes, fill in box B) | <input type="checkbox"/> |
| c) indoor sporting events (if ticking yes, fill in box C) | <input type="checkbox"/> |
| d) boxing or wrestling entertainment (if ticking yes, fill in box D) | <input type="checkbox"/> |
| e) live music (if ticking yes, fill in box E) | <input checked="" type="checkbox"/> |
| f) recorded music (if ticking yes, fill in box F) | <input checked="" type="checkbox"/> |
| g) performances of dance (if ticking yes, fill in box G) | <input checked="" type="checkbox"/> |
| h) anything of a similar description to that falling within (e), (f) or (g) (if ticking yes, fill in box H) | <input checked="" type="checkbox"/> |

Provision of late night refreshment (if ticking yes, fill in box I)

Supply of alcohol (if ticking yes, fill in box J)

In all cases complete boxes K, L and M

A

Plays Standard days and timings (please read guidance note 6)			<u>Will the performance of a play take place indoors or outdoors or both – please tick</u> (please read guidance note 2)	Indoors	<input type="checkbox"/>
Day	Start	Finish		Outdoors	<input type="checkbox"/>
				Both	<input type="checkbox"/>
Mon			<u>Please give further details here</u> (please read guidance note 3)		
Tue					
Wed			<u>State any seasonal variations for performing plays</u> (please read guidance note 4)		
Thur					
Fri			<u>Non standard timings. Where you intend to use the premises for the performance of plays at different times to those listed in the column on the left, please list</u> (please read guidance note 5)		
Sat					
Sun					

B

Films Standard days and timings (please read guidance note 6)			<u>Will the exhibition of films take place indoors or outdoors or both – please tick</u> (please read guidance note 2)	Indoors	<input type="checkbox"/>
Day	Start	Finish		Outdoors	<input type="checkbox"/>
				Both	<input type="checkbox"/>
Mon			<u>Please give further details here</u> (please read guidance note 3)		
Tue					
Wed					
Thur			<u>State any seasonal variations for the exhibition of films</u> (please read guidance note 4)		
Fri					
Sat					
Sun			<u>Non standard timings. Where you intend to use the premises for the exhibition of films at different times to those listed in the column on the left, please list</u> (please read guidance note 5)		

C

Indoor sporting events Standard days and timings (please read guidance note 6)			<u>Please give further details</u> (please read guidance note 3)
Day	Start	Finish	
Mon			
Tue			<u>State any seasonal variations for indoor sporting events</u> (please read guidance note 4)
Wed			
Thur			<u>Non standard timings. Where you intend to use the premises for indoor sporting events at different times to those listed in the column on the left, please list</u> (please read guidance note 5)
Fri			
Sat			
Sun			

D

Boxing or wrestling entertainments Standard days and timings (please read guidance note 6)			<u>Will the boxing or wrestling entertainment take place indoors or outdoors or both – please tick</u> (please read guidance note 2)	Indoors	<input type="checkbox"/>
Day	Start	Finish		Outdoors	<input type="checkbox"/>
Mon				<u>Please give further details here</u> (please read guidance note 3)	
Tue					
Wed					
Thur			<u>State any seasonal variations for boxing or wrestling entertainment</u> (please read guidance note 4)		
Fri					
Sat					
Sun			<u>Non standard timings. Where you intend to use the premises for boxing or wrestling entertainment at different times to those listed in the column on the left, please list</u> (please read guidance note 5)		

E

Live music Standard days and timings (please read guidance note 6)			Will the performance of live music take place <u>indoors or outdoors or both – please tick</u> (please read guidance note 2)	Indoors	<input checked="" type="checkbox"/>
Day	Start	Finish		Outdoors	<input type="checkbox"/>
				Both	<input type="checkbox"/>
Mon	10.00		<u>Please give further details here</u> (please read guidance note 3)		
		00.00			
Tue	10.00				
		00.00			
Wed	10.00		<u>State any seasonal variations for the performance of live music</u> (please read guidance note 4)		
		00.00			
Thur	10.00				
		00.00			
Fri	10.00		<u>Non standard timings. Where you intend to use the premises for the performance of live music at different times to those listed in the column on the left, please list</u> (please read guidance note 5) St George's Day, St Patrick's day and St Valentines Day are 10.00 am to 01.00 am New Years Eve from start of business to close of business on New Year's Day		
		01.00			
Sat	10.00				
		01.00			
Sun	12.00				
		23.00			

F

Recorded music Standard days and timings (please read guidance note 6)			Will the playing of recorded music take place <u>indoors or outdoors or both – please tick</u> (please read guidance note 2)	Indoors	<input checked="" type="checkbox"/>
Day	Start	Finish		Outdoors	<input type="checkbox"/>
				Both	<input type="checkbox"/>
Mon	10.00		<u>Please give further details here</u> (please read guidance note 3)		
		00.00			
Tue	10.00				
		00.00			
Wed	10.00		<u>State any seasonal variations for the playing of recorded music</u> (please read guidance note 4)		
		00.00			
Thur	10.00				
		00.00			
Fri	10.00		<u>Non standard timings. Where you intend to use the premises for the playing of recorded music at different times to those listed in the column on the left, please list</u> (please read guidance note 5) St George's Day, St Patrick's day and St Valentines Day are 10.00 am to 01.00 am New Years Eve from start of business to close of business on New Year's Day		
		01.00			
Sat	10.00				
		01.00			
Sun	12.00				
		23.00			

G

Performances of dance Standard days and timings (please read guidance note 6)			<u>Will the performance of dance take place indoors or outdoors or both – please tick</u> (please read guidance note 2)	Indoors	<input checked="" type="checkbox"/>
Day	Start	Finish		Outdoors	<input type="checkbox"/>
				Both	<input type="checkbox"/>
Mon	10.00		<u>Please give further details here</u> (please read guidance note 3)		
		00.00			
Tue	10.00				
		00.00			
Wed	10.00		<u>State any seasonal variations for the performance of dance</u> (please read guidance note 4)		
		00.00			
Thur	10.00				
		00.00			
Fri	10.00		<u>Non standard timings. Where you intend to use the premises for the performance of dance at different times to those listed in the column on the left, please list</u> (please read guidance note 5) St George's Day, St Patrick's day and St Valentines Day are 10.00 am to 01.00 am New Years Eve from start of business to close of business on New Year's Day		
		01.00			
Sat	10.00				
		01.00			
Sun	12.00				
		23.00			

H

Anything of a similar description to that falling within (e), (f) or (g) Standard days and timings (please read guidance note 6)			Please give a description of the type of entertainment you will be providing		
Day	Start	Finish	<u>Will this entertainment take place indoors or outdoors or both – please tick</u> (please read guidance note 2)	Indoors	<input checked="" type="checkbox"/>
Mon	10.00			Outdoors	<input type="checkbox"/>
		00.00		Both	<input type="checkbox"/>
Tue	10.00		<u>Please give further details here</u> (please read guidance note 3)		
		00.00			
Wed	10.00				
		00.00			
Thur	10.00		<u>State any seasonal variations for entertainment of a similar description to that falling within (e), (f) or (g)</u> (please read guidance note 4)		
		00.00			
Fri	10.00				
		01.00			
Sat	10.00		<u>Non standard timings. Where you intend to use the premises for the entertainment of a similar description to that falling within (e), (f) or (g) at different times to those listed in the column on the left, please list</u> (please read guidance note 5) St George's Day, St Patrick's day and St Valentines Day are 10.00 am to 01.00 am New Years Eve from start of business to close of business on New Year's Day		
		01.00			
Sun	12.00				
		23.00			

I

Late night refreshment Standard days and timings (please read guidance note 6)			Will the provision of late night refreshment take place indoors or outdoors or both – please tick (please read guidance note 2)	Indoors	<input checked="" type="checkbox"/>
Day	Start	Finish		Outdoors	<input type="checkbox"/>
				Both	<input type="checkbox"/>
Mon	23.00		<u>Please give further details here</u> (please read guidance note 3)		
		00.00			
Tue	23.00				
		00.00			
Wed	23.00		<u>State any seasonal variations for the provision of late night refreshment</u> (please read guidance note 4)		
		00.00			
Thur	23.00				
		00.00			
Fri	23.00		<u>Non standard timings. Where you intend to use the premises for the provision of late night refreshment at different times, to those listed in the column on the left, please list</u> (please read guidance note 5) St George's Day, St Patrick's day and St Valentines Day are 11.00 pm to 01.00 am New Years Eve from 11 pm to 05.00 am on New Year's Day		
		01.00			
Sat	23.00				
		01.00			
Sun	23.00				
		23.00			

J

Supply of alcohol Standard days and timings (please read guidance note 6)			<u>Will the supply of alcohol be for consumption – please tick</u> (please read guidance note 7)	On the premises	<input type="checkbox"/>
				Off the premises	<input type="checkbox"/>
				Both	<input checked="" type="checkbox"/>
Day	Start	Finish	<u>State any seasonal variations for the supply of alcohol</u> (please read guidance note 4)		
Mon	10.00	00.00			
Tue	10.00	00.00			
Wed	10.00	00.00			
Thur	10.00	00.00			
Fri	10.00	01.00			
Sat	10.00	01.00			
Sun	12.00	23.00	<u>Non standard timings. Where you intend to use the premises for the supply of alcohol at different times to those listed in the column on the left, please list</u> (please read guidance note 5) St George's Day, St Patrick's day and St Valentines Day are 10.00 am to 01.00 am New Years Eve from start of business to close of business on New Year's Day		

State the name and details of the individual whom you wish to specify on the licence as designated premises supervisor:

Name Jack Peacock	
8 Wellington Road Uxbridge	
Postcode	UB8 2AP
Personal licence number (if known) LBHIL0611	
Issuing licensing authority (if known) London Borough of Hillingdon	

K

Please highlight any adult entertainment or services, activities, other entertainment or matters ancillary to the use of the premises that may give rise to concern in respect of children (please read guidance note 8).

None

L

Hours premises are open to the public Standard days and timings (please read guidance note 6)			<u>State any seasonal variations</u> (please read guidance note 4)
Day	Start	Finish	
Mon	10.00	00.30	
Tue	10.00	00.30	
Wed	10.00	00.30	
Thur	10.00	00.30	
Fri	10.00	01.30	
Sat	10.00	01.30	
Sun	12.00	23.30	

Non standard timings. Where you intend the premises to be open to the public at different times from those listed in the column on the left, please list (please read guidance note 5)

St George's Day, St Patrick's day and St Valentines Day are 10.00 am to 01.00 am
New Years Eve from start of business to close of business on New Year's Day

M Describe the steps you intend to take to promote the four licensing objectives:

a) General – all four licensing objectives (b, c, d and e) (please read guidance note 9)

Conditions attached to Club Premises Licence to be included as appropriate
 Licence to be used where the ground floor of the premises is hired to a member in person for a private function for business, domestic or social events.
 Persons who are guests of such a member may be admitted and alcohol may be sold or supplied to such person.
 An event or function register will be maintained containing details of all such hirings and is to be available to police officers or authorised officers of the Licensing Authority on request.
 Gaming Machines registered to the Club will be switched off on the occasion of hirings.
 Licence applicable to the ground floor only

b) The prevention of crime and disorder

Age restriction policy is Challenge 21
 A secure entry system to the premises will be maintained.
 CCTV system will be maintained and images retained for 28 days and made available to police and authorised officers of the Council on request.
 No 18th birthday party events. No 'stag' nights.

c) Public safety

Risk assessments to be carried out at regular intervals

d) The prevention of public nuisance

Notices are to be displayed and maintained at all exits requesting member and guests to leave the club and car park quietly. Notices are to be displayed and maintained requesting members and guests to wait in the foyer for taxis.
 The club will close 30 mins after the end of the time permitted for licensable activities.
 Members and guests are not permitted to use the raised patio area after 10.00 pm
 There shall be no audible noise from the premises at the boundary of residential premises in the vicinity of the premises.

e) The protection of children from harm

No risks to children identified.
 No adult entertainments proposed.
 Age restriction policy is Challenge 21
 Children will not be admitted after 19.00 unless the event is a family or domestic occasion
 All children to be accompanied by a responsible adult person when at the club premises.

Checklist:**Please tick to indicate agreement**

- I have made or enclosed payment of the fee.
- I have enclosed the plan of the premises. (ground floor)
- I have sent copies of this application and the plan to responsible authorities and others where applicable.
- I have enclosed the consent form completed by the individual I wish to be designated premises supervisor, if applicable.
- I understand that I must now advertise my application.
- I understand that if I do not comply with the above requirements my application will be rejected.

IT IS AN OFFENCE, LIABLE ON SUMMARY CONVICTION TO A FINE NOT EXCEEDING LEVEL 5 ON THE STANDARD SCALE, UNDER SECTION 158 OF THE LICENSING ACT 2003, TO MAKE A FALSE STATEMENT IN OR IN CONNECTION WITH THIS APPLICATION.

Part 4 – Signatures (please read guidance note 10)

Signature of applicant or applicant’s solicitor or other duly authorised agent (see guidance note 11).
If signing on behalf of the applicant, please state in what capacity.

Signature	
Date	30 th November 2015
Capacity	Solicitor for the Applicant Company

For joint applications, signature of 2nd applicant or 2nd applicant’s solicitor or other authorised agent (please read guidance note 12). **If signing on behalf of the applicant, please state in what capacity.**

Signature	
Date	
Capacity	

Contact name (where not previously given) and postal address for correspondence associated with this application (please read guidance note 13) David Smith Solicitor Turbervilles Hill House, High Street			
Post town	Uxbridge	Postcode	UB8 1JT
Telephone number (if any)	07850 303271		
If you would prefer us to correspond with you by e-mail, your e-mail address (optional) david.smith@turbervilles.co.uk			

Notes for Guidance

1. Describe the premises, for example the type of premises, its general situation and layout and any other information which could be relevant to the licensing objectives. Where your application includes off-supplies of alcohol and you intend to provide a place for consumption of these off-supplies, you must include a description of where the place will be and its proximity to the premises.
2. Where taking place in a building or other structure please tick as appropriate (indoors may include a tent).
3. For example the type of activity to be authorised, if not already stated, and give relevant further details, for example (but not exclusively) whether or not music will be amplified or unamplified.
4. For example (but not exclusively), where the activity will occur on additional days during the summer months.
5. For example (but not exclusively), where you wish the activity to go on longer on a particular day e.g. Christmas Eve.
6. Please give timings in 24 hour clock (e.g. 16:00) and only give details for the days of the week when you intend the premises to be used for the activity.
7. If you wish people to be able to consume alcohol on the premises, please tick 'on the premises'. If you wish people to be able to purchase alcohol to consume away from the premises, please tick 'off the premises'. If you wish people to be able to do both, please tick 'both'.
8. Please give information about anything intended to occur at the premises or ancillary to the use of the premises which may give rise to concern in respect of children, regardless of whether you intend children to have access to the premises, for example (but not exclusively) nudity or semi-nudity, films for restricted age groups or the presence of gaming machines.
9. Please list here steps you will take to promote all four licensing objectives together.
10. The application form must be signed.
11. An applicant's agent (for example solicitor) may sign the form on their behalf provided that they have actual authority to do so.
12. Where there is more than one applicant, each of the applicant or their respective agent must sign the application form.
13. This is the address which we shall use to correspond with you about this application.

This drawing and the building works depicted are the copyright of Transformation Ltd. and may not be reproduced except by written permission.

GENERAL NOTES

All work to be carried out in accordance with the current building regulations and all other statutory requirements.

Contractor must verify dimensions at the job before commencing any work or making any shop drawings.

Any discrepancy in the drawings must be reported to the design office.

KEY

- (CONCEALED LIGHTING OVER LOUNGE, WINDOW BAYS + REAR OF BAR). 5 FOOT SLIM FLUORESCENT SINGLE FITTING.
- (OVER LOUNGE). 3 FOOT SINGLE FLUORESCENT FITTING.
- (ARTISTE + LADIES W.C. + DOORMAN). 4 FOOT SINGLE FLUORESCENT FITTING.
- (KITCHEN + GENTS W.C.). 5 FOOT SINGLE FLUORESCENT FITTING.
- (BEER STORE). 8 FOOT SINGLE FLUORESCENT FITTING.
- (RECESSED OVER SERVERY + ENTRANCE TO LOUNGE). DRUMLINE FITTING.
- (SURFACE MOUNTED AT BASE OF STAIRS + FOYER). 60 WATT LAMP, DRUMLINE FITTING.
- (W.C. CUBICLES + CUP'D). 75 WATT LAMP, DRUMLINE FITTING.
- (ILLUMINATING STAGE). SPOT LIGHTING FITTING.
- (ILLUMINATED SIGN) TO FIRE EXIT/ FIRE EXIT.
- EMERGENCY LIGHT FITTER
- EXTERIOR LIGHTING.
- FIRE ALARM PUSH BUTTON.
- FIRE ALARM.

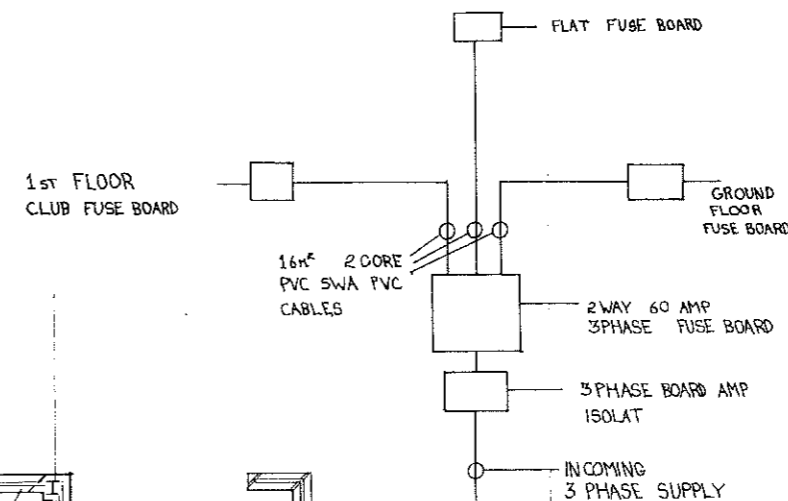
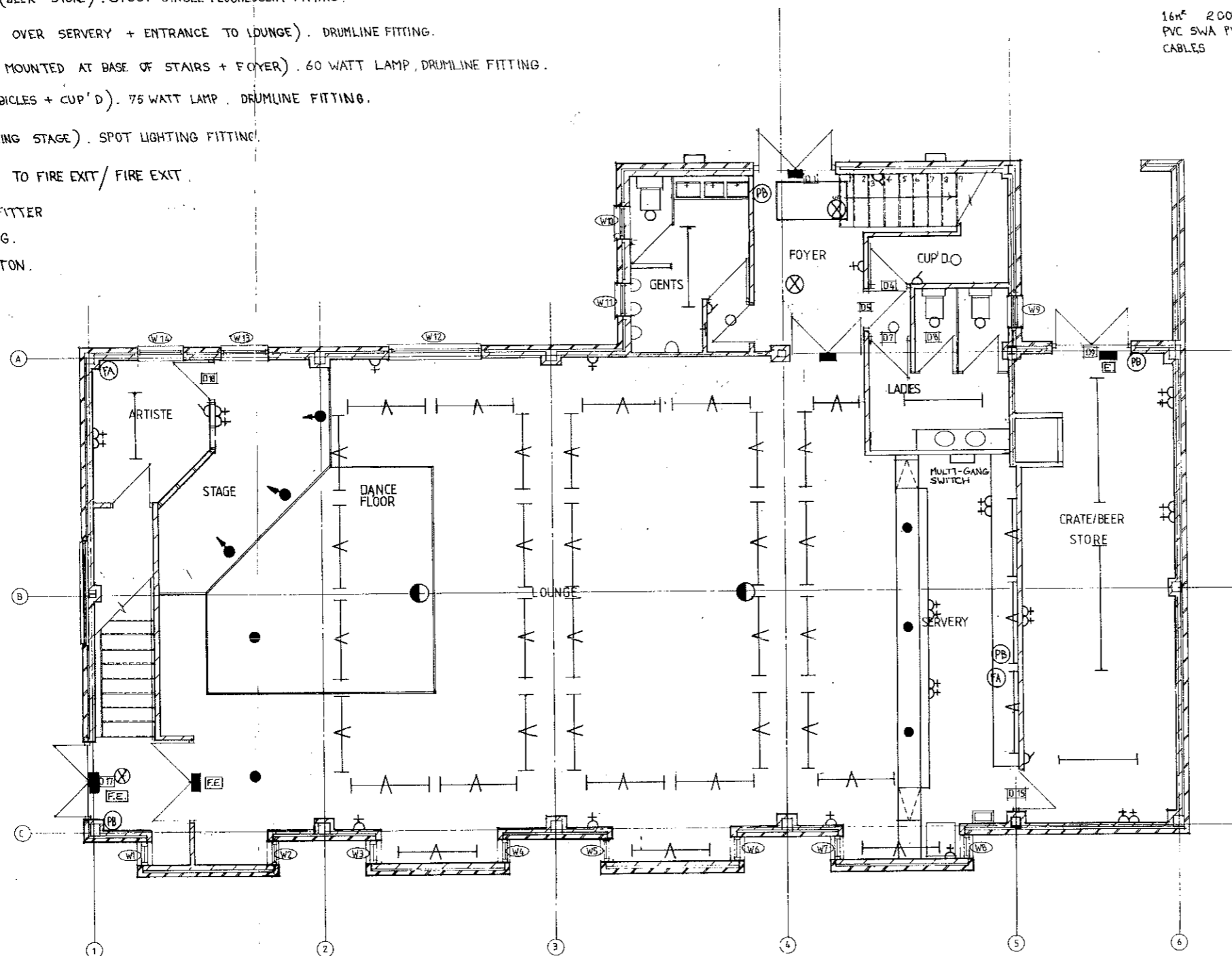

Revisions	NO	date	drawn
REVISED GROUND FLOOR ELECTRICAL APPLIANCE LAYOUT TO SUIT NEW SCHEME WORKING DRAWING NO. 15.		24-3-82	R.S.
ILLUMINATED FIRE SIGNS ADDED & DOOR SWINGS ALTERED TO COMPLY WITH FIRE REGULATIONS. DRAWING SENT TO LASTER CONSTRUCTION LTD.	B	7/2/82	H.S.M.

THE IVY LEAF CLUB
WELLINGTON ROAD
UXBRIDGE

WORKING DRAWING- GROUND FLOOR
ELECTRICAL APPLIANCES

scale 1:50
date drawn P.D.A.Z.

transformation design group limited
Architectural + Interior Designers
276 Tong Road
Leeds LS12 4NQ
Tel Leeds (0532) 634311/7



Transformation Design Group (South) Ltd
Market Chambers, Shelton Square, Coventry CV1 1DJ
Tele (0302) 28221

contract number	drawing number	revision	system ref
TCV81/021	11	B	